

CERTAIN ITEMS SHOWN ON THE DRAWING MAY BE SUBJECT TO CHANGE ORDER APPROVAL. VARIOUS ITEMS SHOWN ON THE DRAWING ARE OWNER FURNISHED OR ADDENDUM ITEMS PER THE TERMS OF THE CONTRACT AND SHIP'S SPECIFICATION.

REVISIONS			
NO.	DESCRIPTION	BY	DATE
1.	REDUCED TRANSOM LENGTH BY 12" AND ADDED 12" TO BOW	CAC	9/8/08
2.	MODIFIED BOW RAKE		
3.	ADDED HULL SHADING BELOW THE SHEER LINE		
4.	RELOCATED LIFE RAFTS, BULWARK GATES, AND MODIFIED CARBON FIBER DECK SOCKETS		
5.	ADDED RAIN HATCH ABOVE 02 DECK EXTERIOR STAIRS		
6.	REVISED 02 DECK ARRANGEMENT PER NUHOUSE DRAWINGS		
7.	MODIFIED FLAGSTAFF, ENG RM VENTILATION LOUVER, SIDELIGHT CUTOUT, AND FOREDECK STAIRS		

REFERENCES		
NO.	DWG NO.	TITLE

TRINITY YACHTS
 13085 SEAWAY ROAD
 GULFBORO, MS 39503
 228-276-1000
 FAX 228-276-1002

This drawing, design concept, and specifications are the property of TRINITY YACHTS, L.L.C. and are furnished on a confidential basis with an expressed understanding that they will not be copied in any manner, used for manufacture, sold, transferred, nor used to the detriment of said firm without written permission. The recipient further agrees not to disclose these contents hereof to any other parties except for those specific purposes for which this drawing was issued.

APPROVALS
 TY _____ CLASS _____
 OWNER _____ FLAG _____

168' TRI-DECK MOTOR YACHT PROFILE AND OUTBOARD VIEWS		
SCALE: 3/16"=1'-0"	DATE: 11/4/13	DWG NO. 10111-00
DRAWN BY: _____	CK'D BY: CC	SHT 1 OF 1
HULL NO.: 052	JOB NO.: T052-SHOW	REV 1

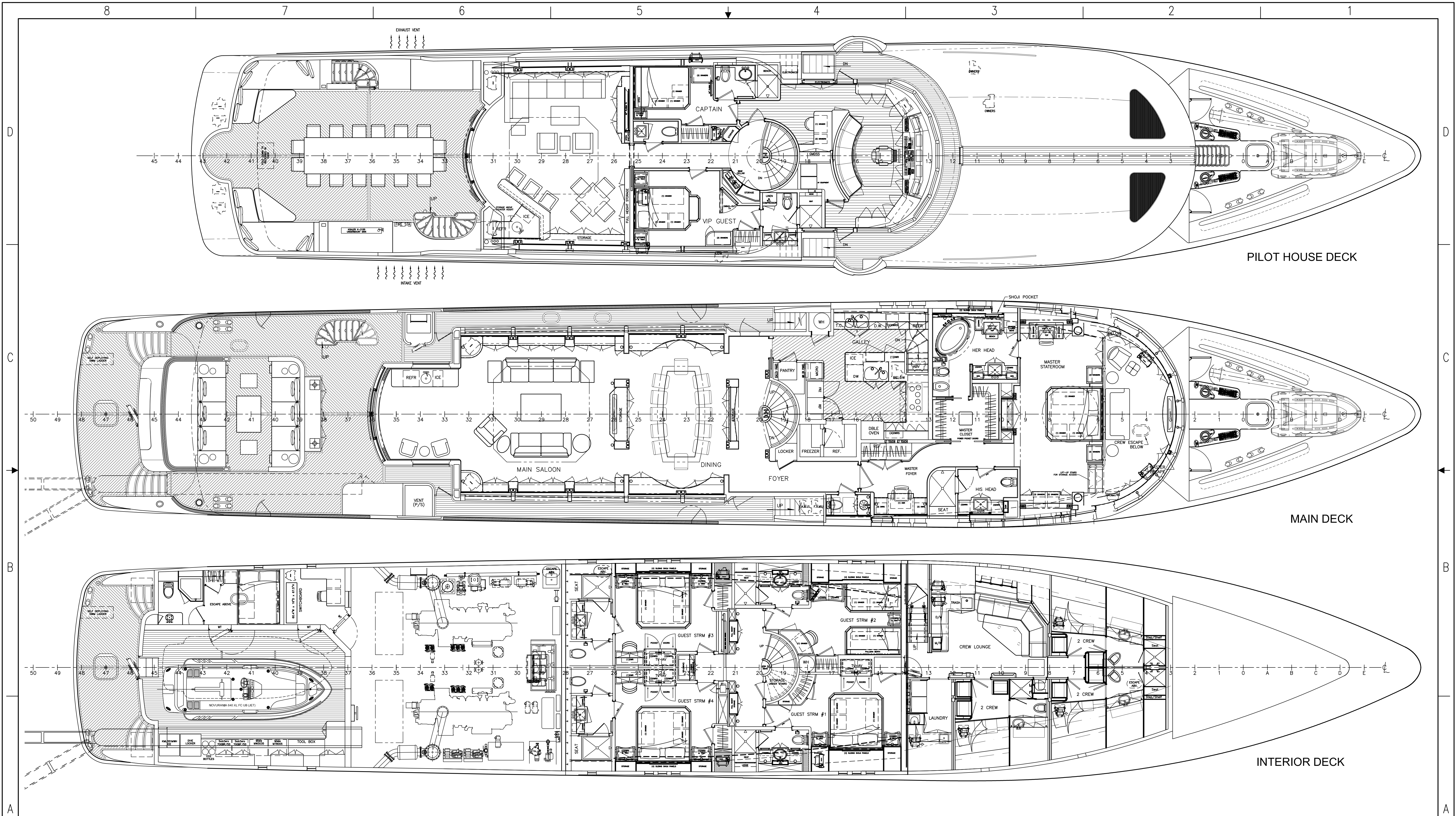

CERTAIN ITEMS SHOWN ON THE DRAWING MAY BE SUBJECT TO CHANGE ORDER APPROVAL. VARIOUS ITEMS SHOWN ON THE DRAWING ARE OWNER FURNISHED OR ADDENDUM ITEMS PER THE TERMS OF THE CONTRACT AND SHIP'S SPECIFICATION.

REVISIONS			
NO.	DESCRIPTION	BY	DATE
1.	1. REDUCED TRANSOM LENGTH BY 12" AND ADDED 12" TO BOW	CAC	9/8/08
	2. UPDATED ARRANGEMENTS TO REFLECT LATEST NUHOUSE INTERIOR DRAWINGS		
	3. REVISED FOREDECK ANCHOR HANDLING PLINTH		
	4. MOVED 01 DECK STANCHIONS OUTBOARD & CHANGED ALL EXT. STANCHIONS TO 6"x4" RECT TUBE		
	5. MOVED AFT 01 DECK RECESSED TV		
	6. MODIFIED NOTCH FORWARD OF MASTER STRM WINDOWS TO HAVE 5 TALL WINDOWS		
	7. MODIFIED SHAPE OF PORT SIDE VENT TRUNK AT MAIN DECK LEVEL		
	8. MODIFIED AFT MD RAISED PLATFORM TO SUIT OWNER'S REQUEST		
	9. UPDATED LAZARETTE AND ADDED ACTUAL PASSERELLE TO DWG		

REFERENCES		
NO.	DWG NO.	TITLE

TRINITY YACHTS
 13085 SEAWAY ROAD
 GULFPORT, MS 39503
 228-276-1000
 FAX 228-276-1002

This drawing, design concept, and specifications are the property of TRINITY YACHTS, L.L.C. and are furnished on a confidential basis with an expressed understanding that they will not be copied in any manner, used for manufacture, sold, transferred, nor used to the detriment of said firm without written permission. The recipient further agrees not to disclose these contents hereof to any other parties except for those specific purposes for which this drawing was issued.

APPROVALS
 TY _____ CLASS _____
 OWNER _____ FLAG _____

168' TRI-DECK MOTOR YACHT GENERAL ARRANGEMENT		
SCALE: 3/16"=1'-0"	DATE: 11/4/13	DWG NO. 10112-00
DRAWN BY: _____	CK'D BY: CC	SHT 1 OF 1
HULL NO.: 052	JOB NO.: T052-SHOW	REV P

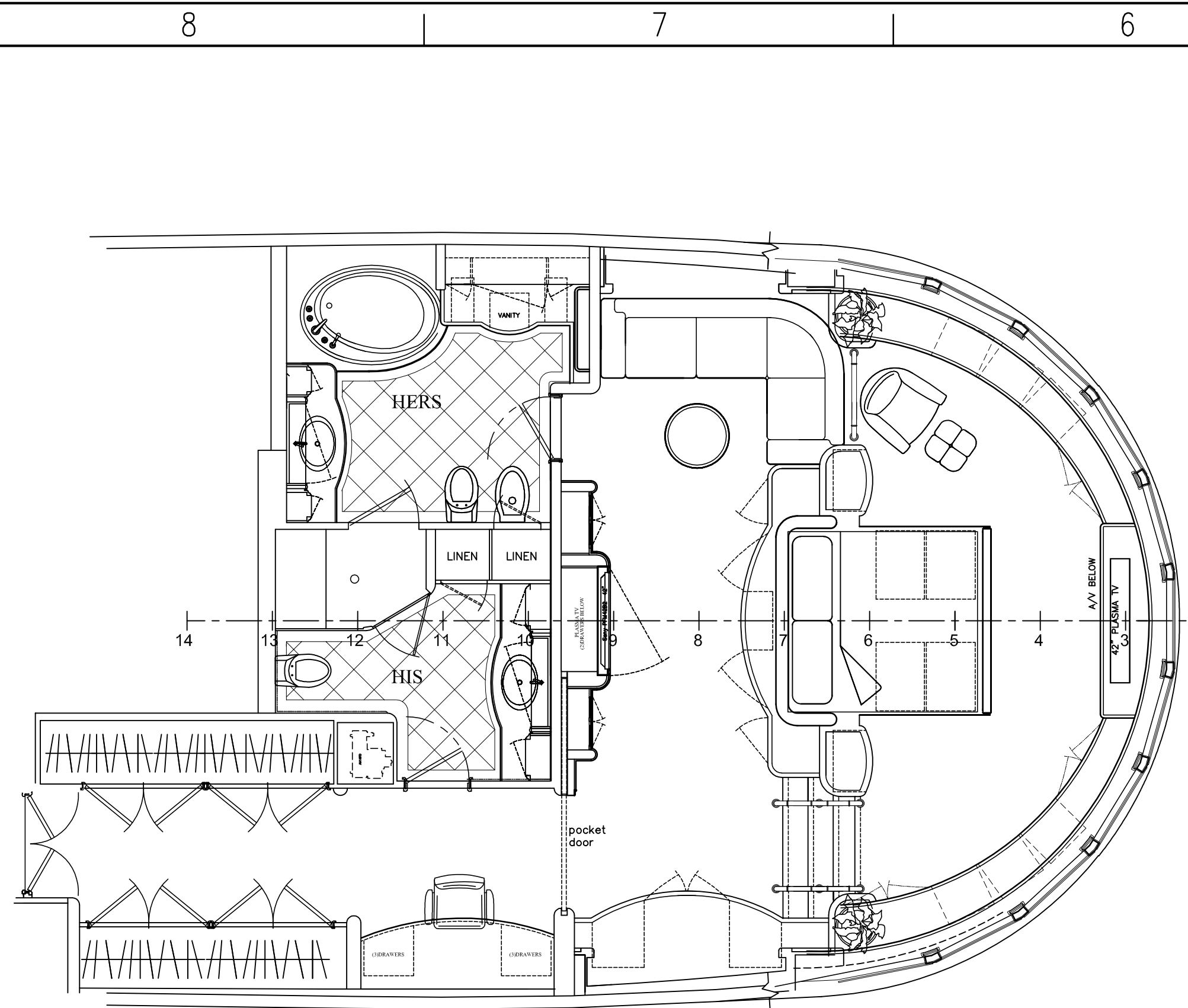

MASTER SR - OPTION A (T030)

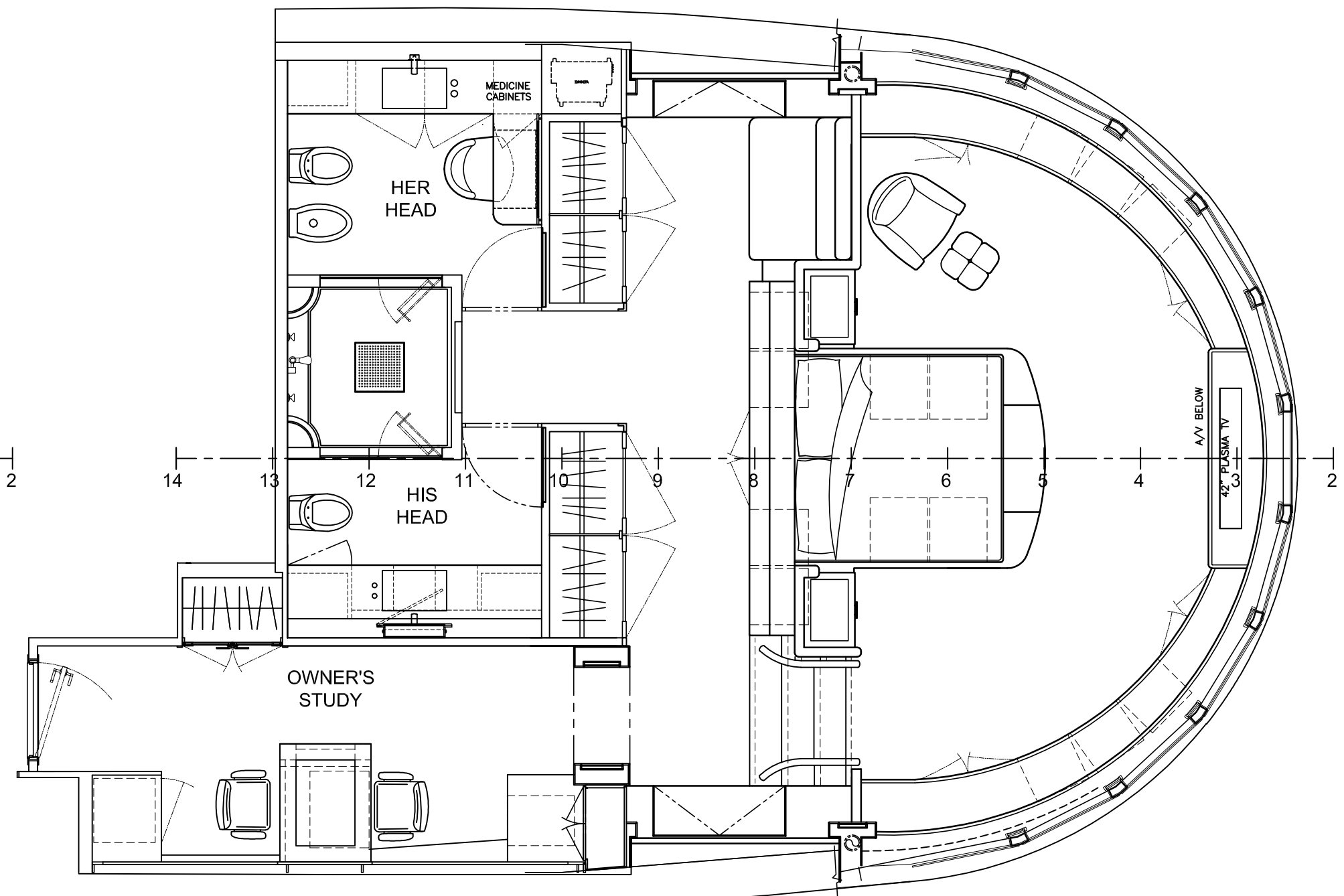

MASTER SR - OPTION B (T057)

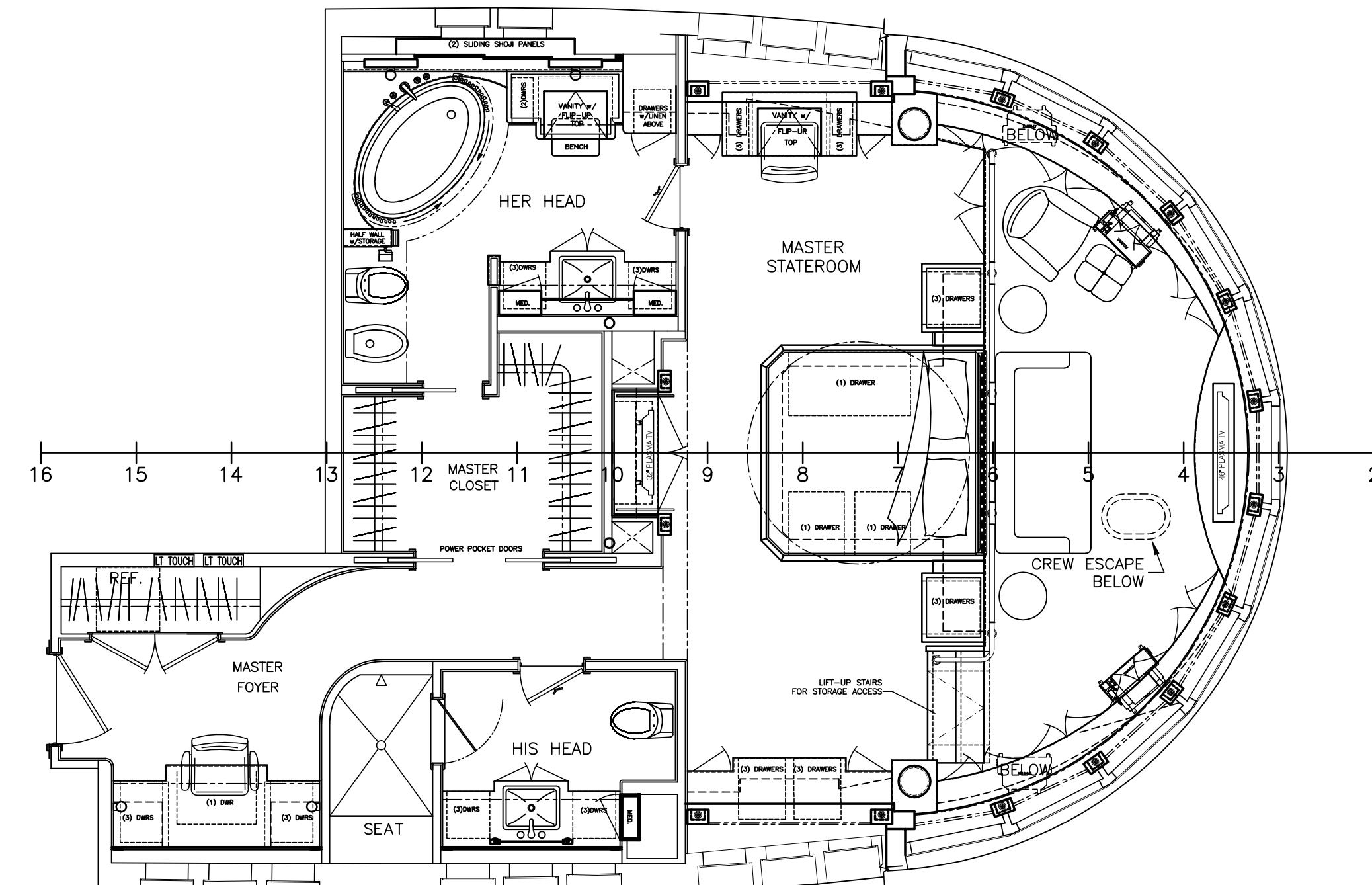

MASTER SR - OPTION C (T055)

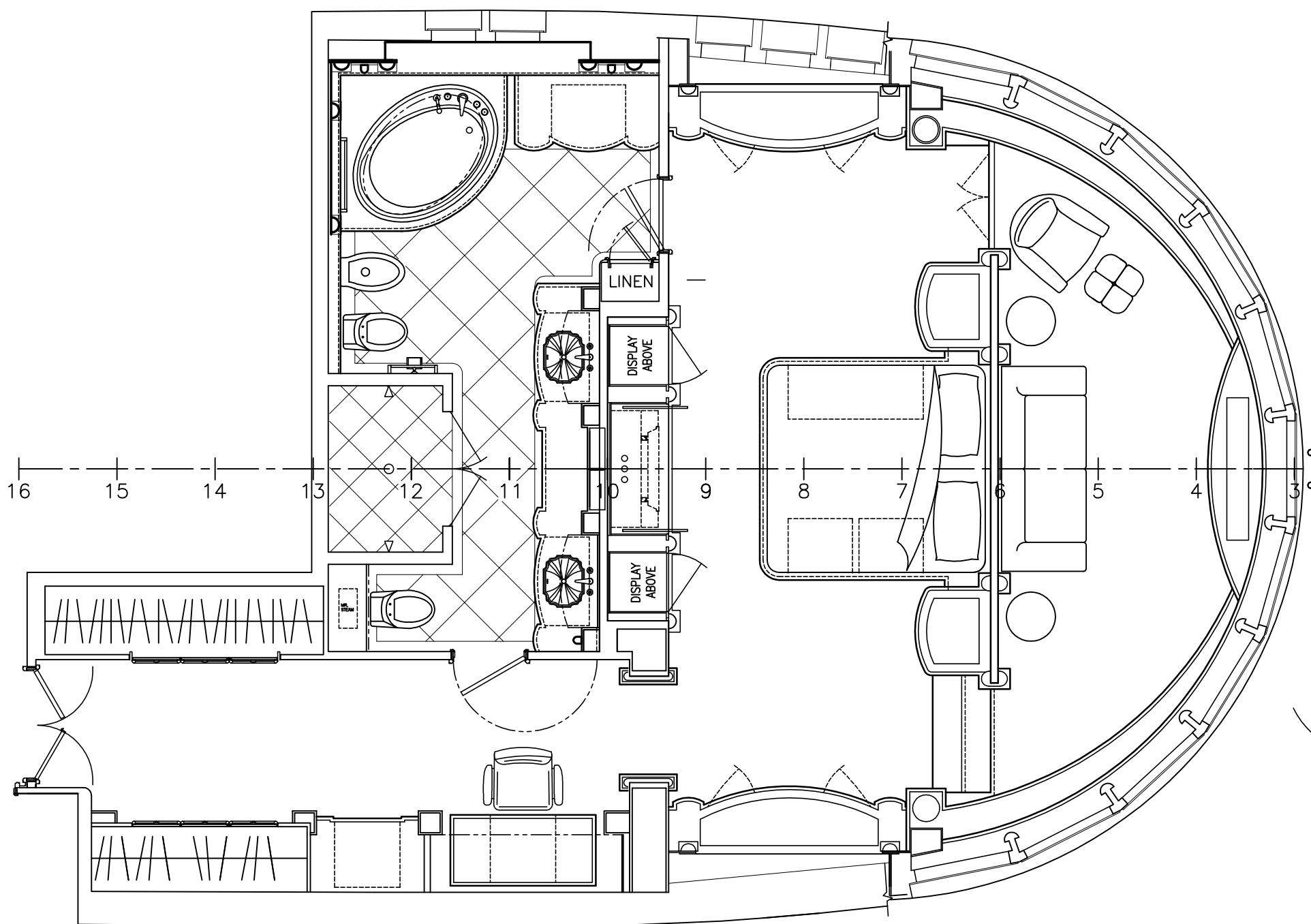

MASTER SR - OPTION D (T034)

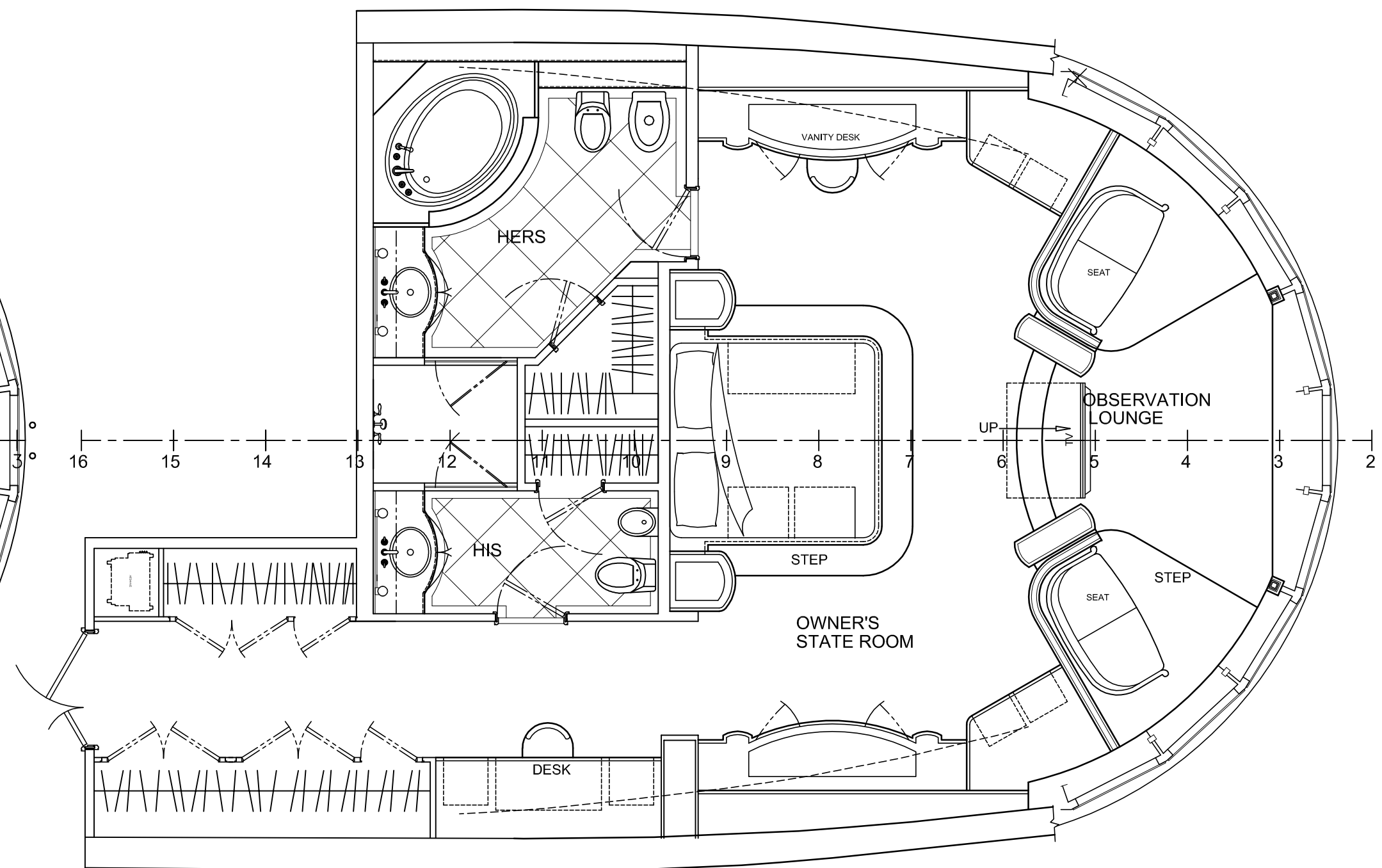

MASTER SR - OPTION E

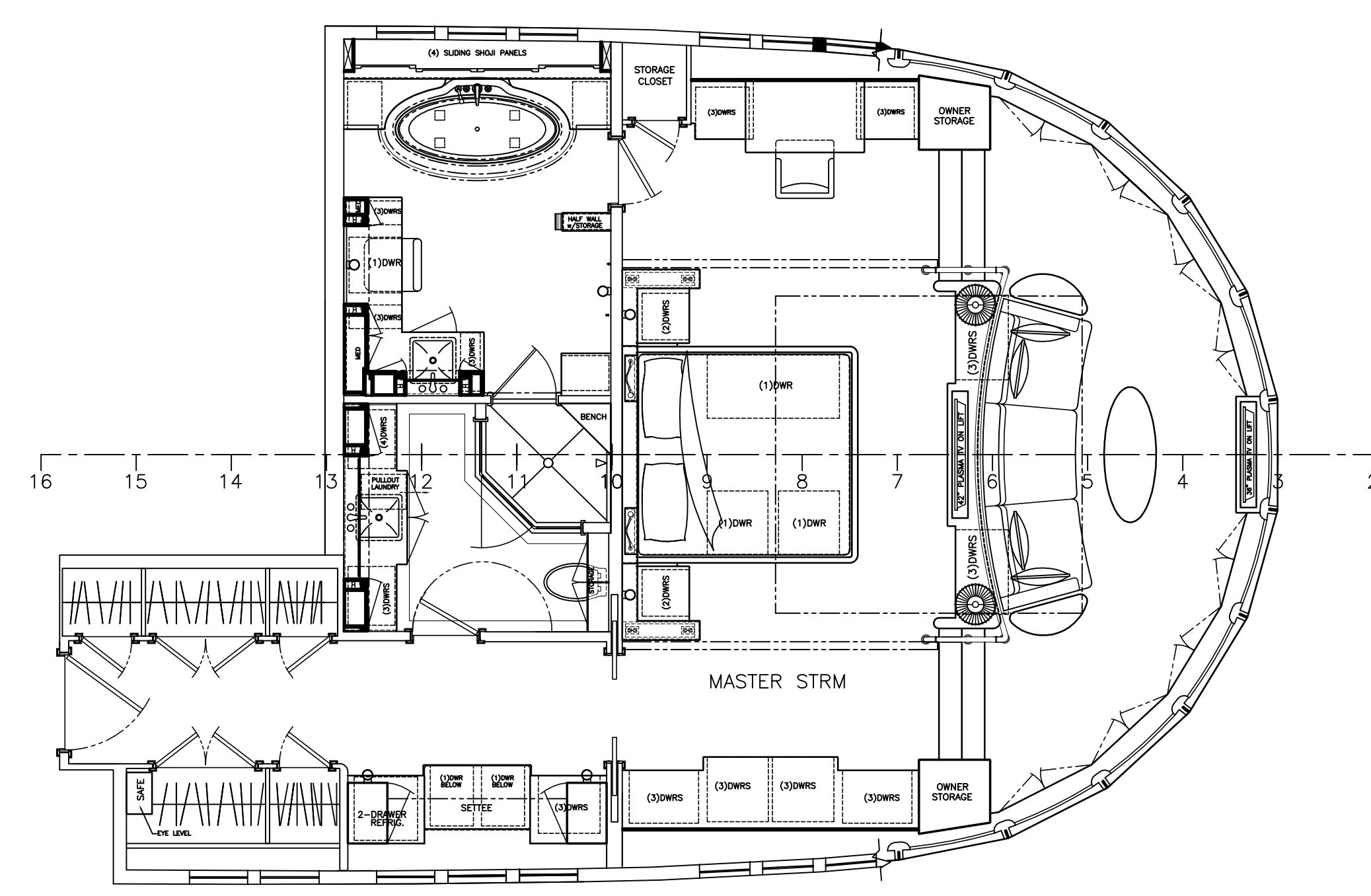

MASTER SR - OPTION F (T049)

 <p>13085 SEAWAY ROAD GULFPORT, MS 39503 228-276-1000 FAX 228-276-1002</p> <p>This drawing, design concept, and specifications are the property of TRINITY YACHTS, L.L.C. and are furnished on a confidential basis with an expressed understanding that they will not be copied in any manner, used for manufacture, sold, transferred, nor used to the detriment of said firm without written permission. The recipient further agrees not to disclose these contents here to any other parties except for those specific purposes for which this drawing was issued.</p>	<p>TRI-DECK MOTOR YACHT ALTERNATE RAISED MASTER ARRANGEMENTS</p>		
	<p>APPROVALS</p> <p>TY _____ CLASS _____</p> <p>OWNER _____ FLAG _____</p>	<p>SCALE: 1/4"=1'-0"</p> <p>DRAWN BY: _____</p> <p>HULL NO.: _____</p>	<p>DATE: _____</p> <p>CK'D BY: JDIII</p> <p>JOB NO.: _____</p>

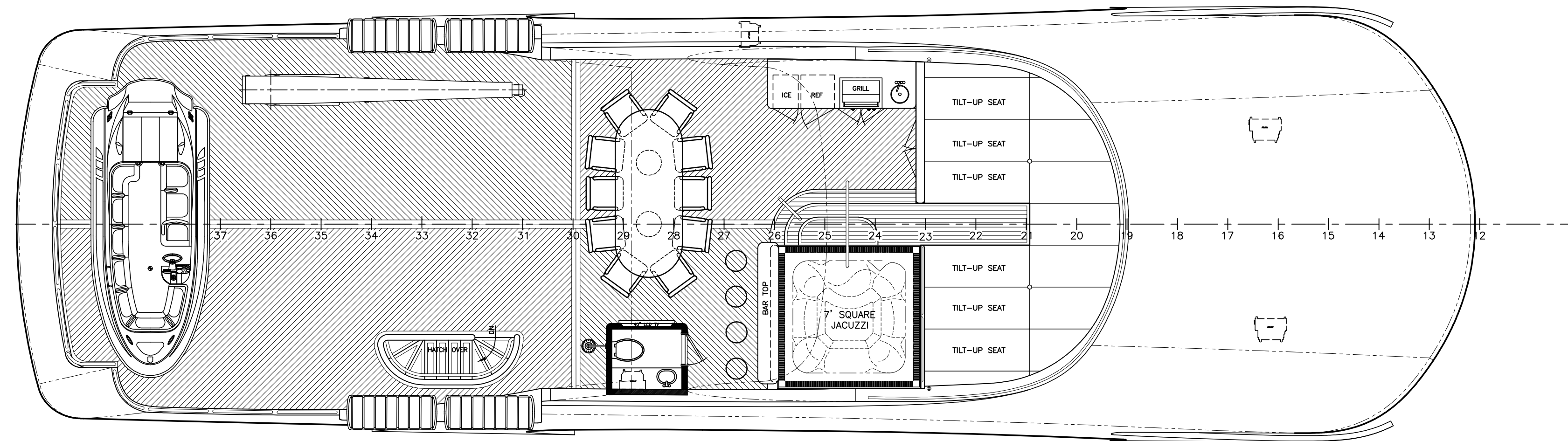

02 DECK OPTION 1

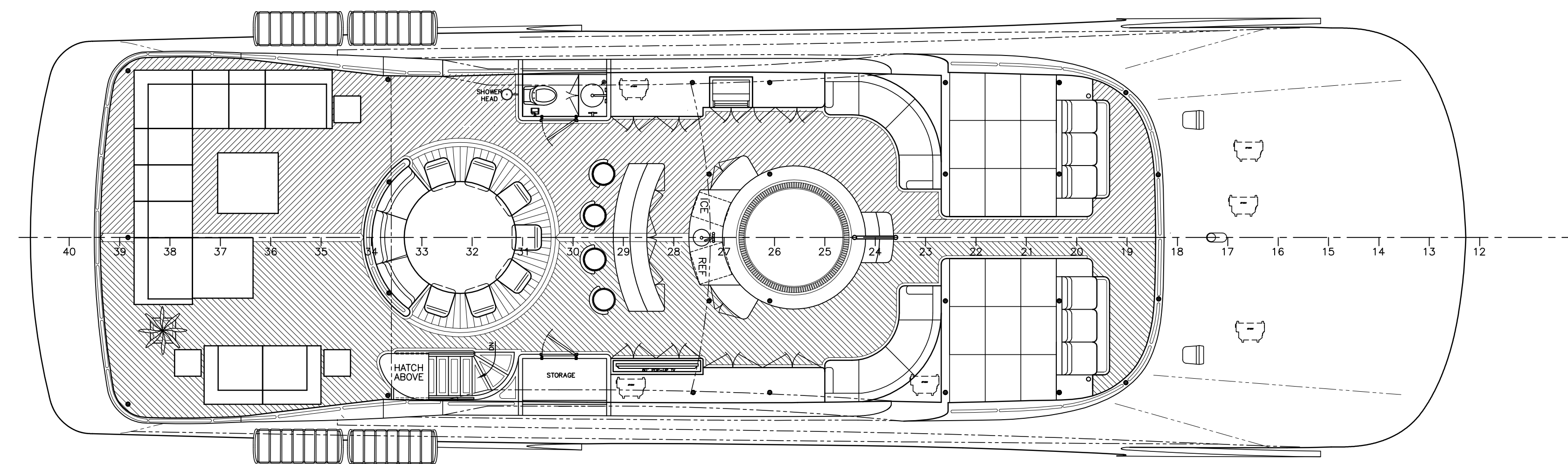

02 DECK OPTION 2

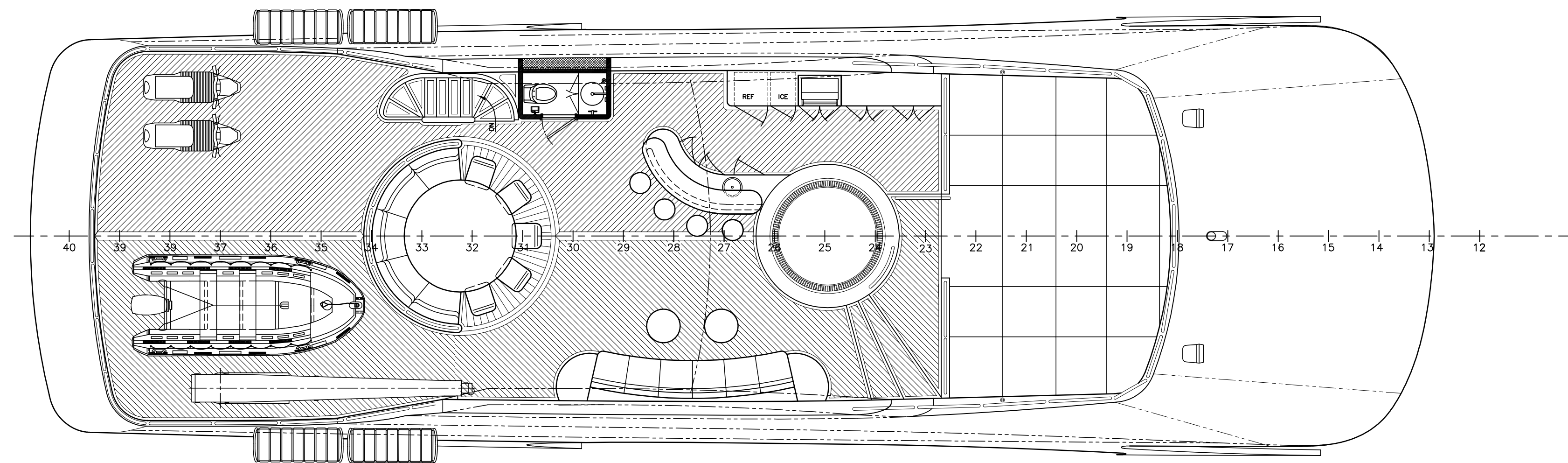

02 DECK OPTION 3

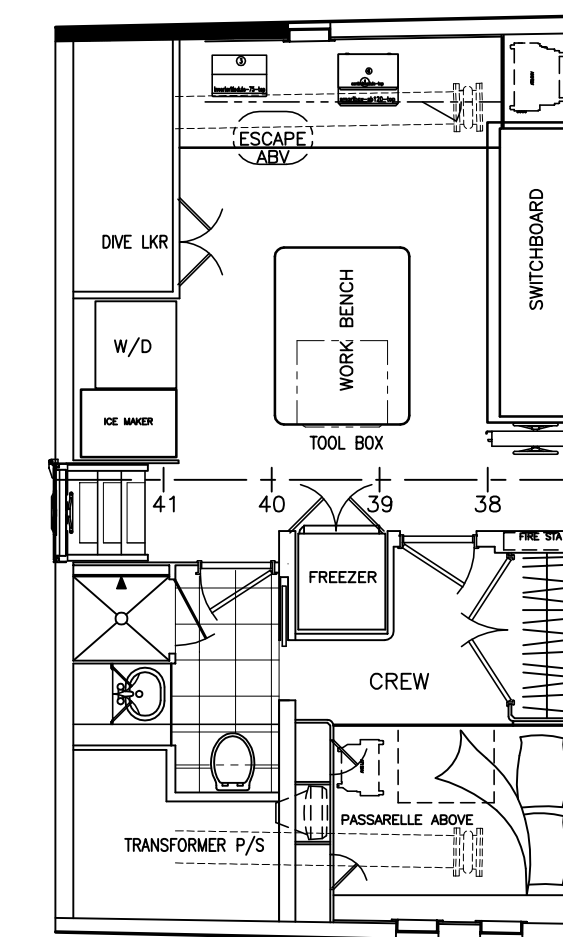

LAZARETTE
OPTION

ITEMS OR EQUIPMENT SHOWN ARE NOT
NECESSARILY PROVIDED BY THE BUILDER.

<p>4325 FRANCE ROAD NEW ORLEANS, LA 70126 504-283-4050 FAX 504-284-7171</p> <p>This drawing, design concept, and specifications are the property of TRINITY YACHTS, L.L.C. and are furnished on a confidential basis with an expressed understanding that they will not be copied in any manner, used for manufacture, sold, transferred, nor used to the detriment of said firm without written permission. The recipient further agrees not to disclose these contents hereof to any other parties except for those specific purposes for which this drawing was issued.</p>	168' TRI-DECK MOTOR YACHT ARRANGEMENT OPTIONS		
	SCALE: 3/16"=1'-0" DRAWN BY: _____ HULL NO.: _____	DATE: 10/31/07 CK'D BY: _____ JOB NO.: _____	DWG NO. 10111-00 SHT 1 OF 1 REV _____
APPROVALS TY _____ CLASS _____ OWNER _____ FLAG _____			

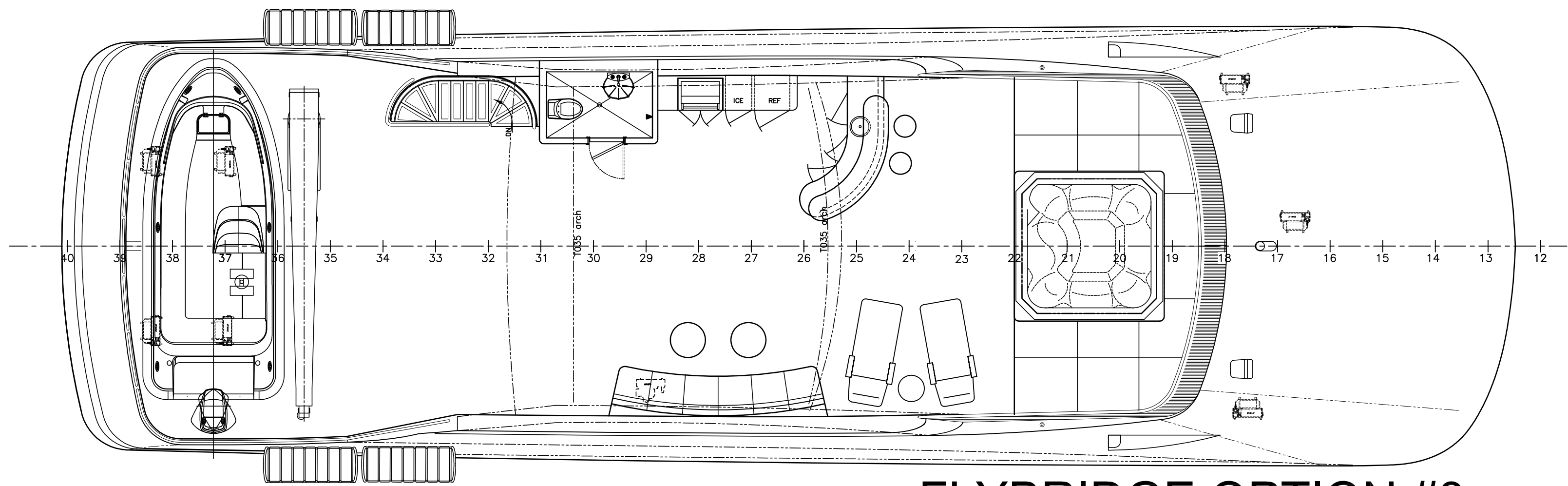

FLYBRIDGE OPTION #3

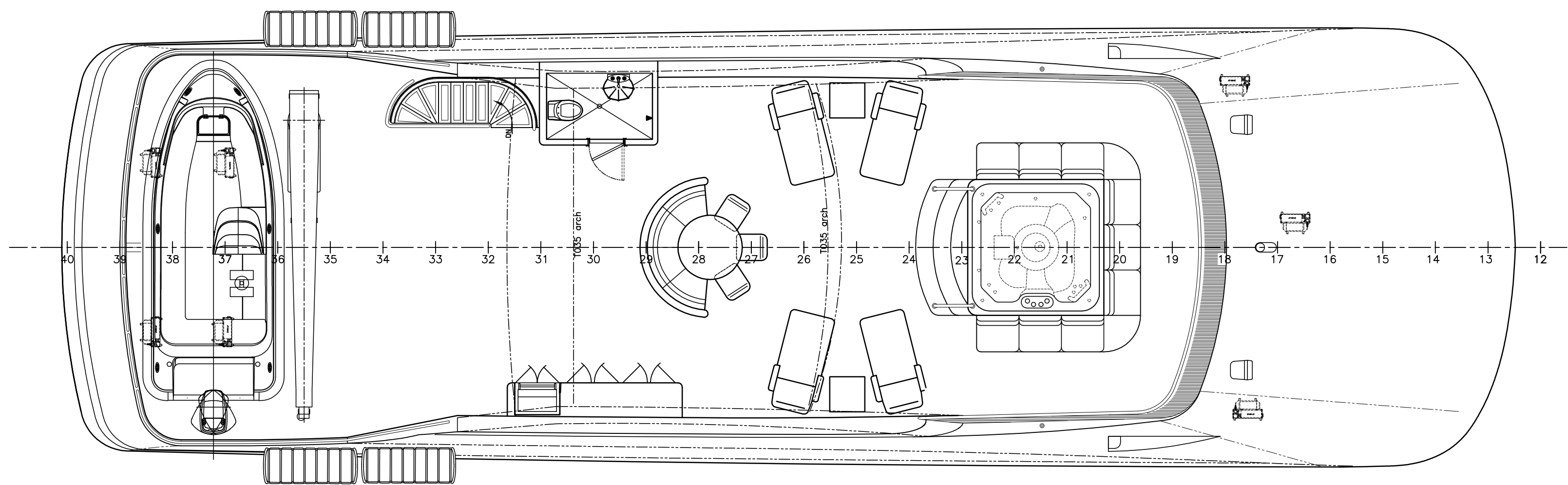

FLYBRIDGE OPTION #2

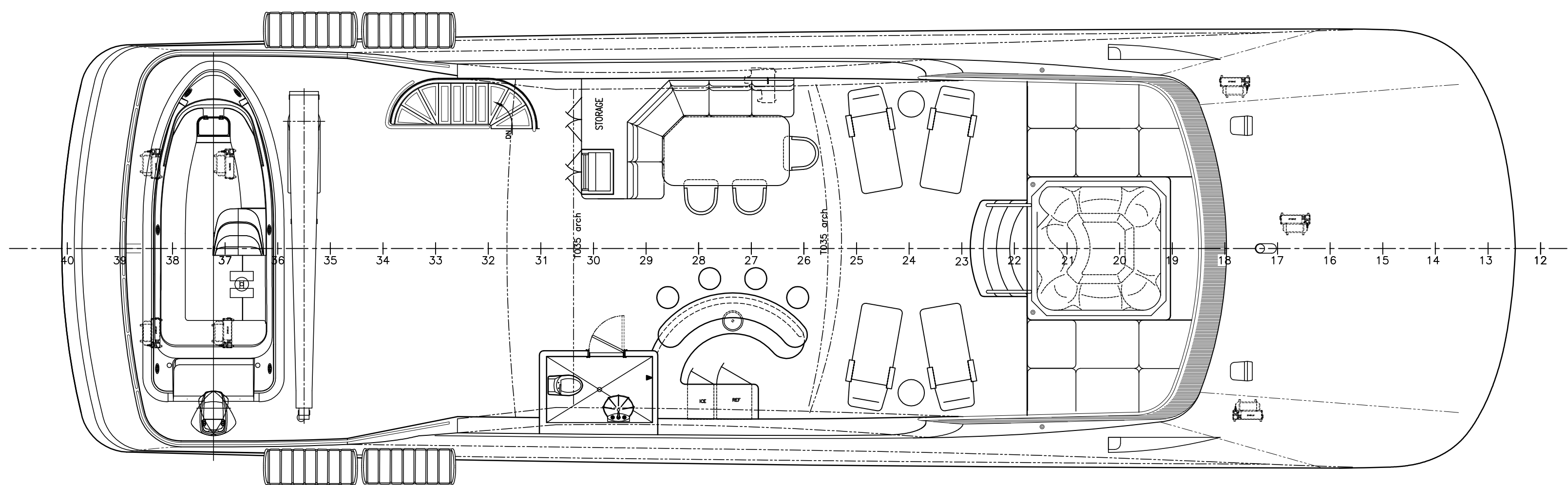

FLYBRIDGE OPTION #1

